

# DE396 ANGLE SEPARATOR DUNNAGE

## 1.63" INDEX

## 10° ANGLE

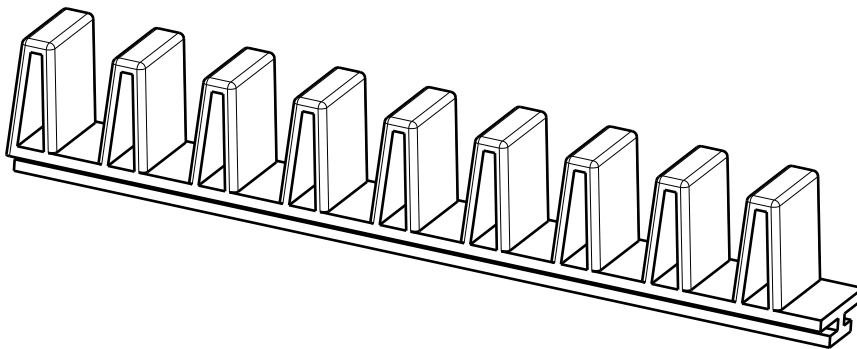
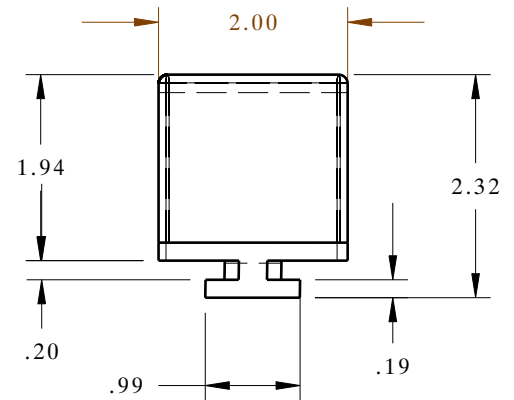
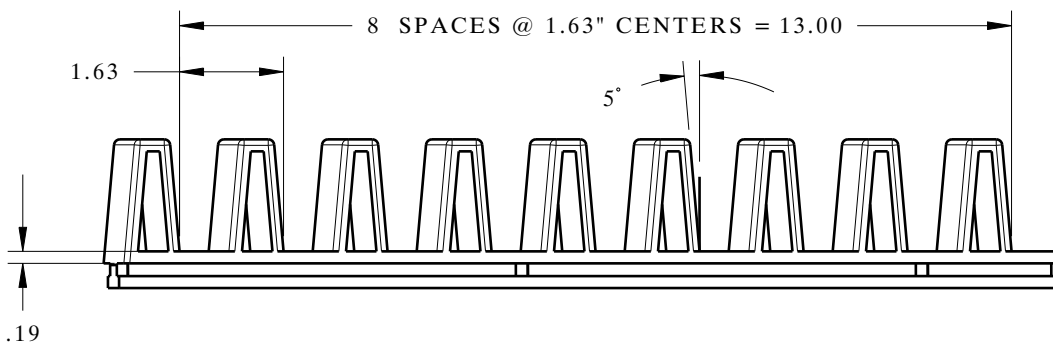
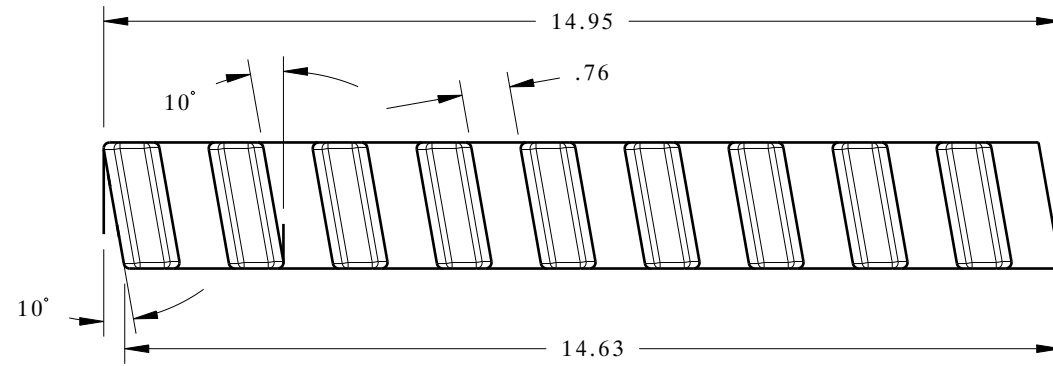

<b>DE396-R</b>	<b>SHOWN</b>
<b>DE396-L</b>	<b>OPPOSITE</b>

<b>MATERIAL TYPE</b> Thermoplastic Elastomer (TPE)
<b>HARDNESS (SHORE A)</b> 90 (Stock), Call
<b>COLOR</b> Gray (Stock)

<b>ANGLE SEPARATOR DUNNAGE</b>
<b>Applications:</b>
-Base Dunnage - Curved Panel
-Side Dunnage - panel with 10° Lean



**Dunnage Engineering**

800-443-5553      www.dunnage-eng.com