

Assembly Methods for Coated Steel Dunnage Bars

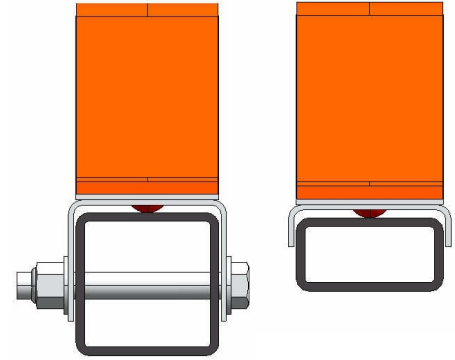

Channel fits over steel tube. Fastened via bolts, screws, or tack welds.

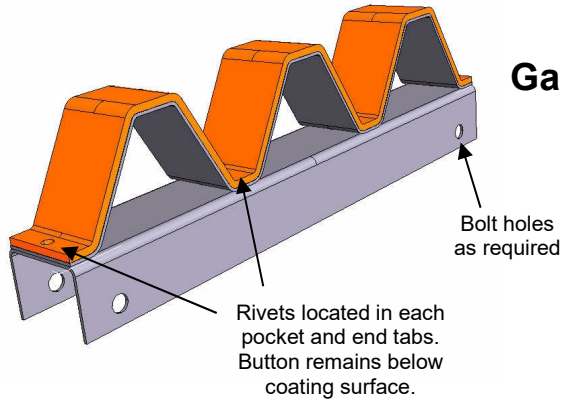
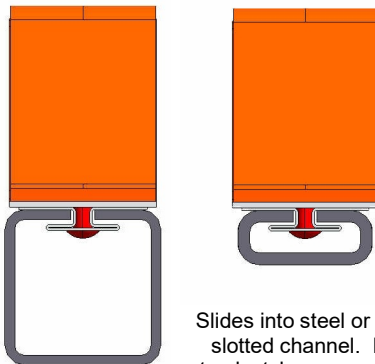

Slides into steel or aluminum slotted channel. Retainer track styles are available for .315" (8mm) or .625" (16mm) wide slot c-channels.

Galvanized Steel Retainer

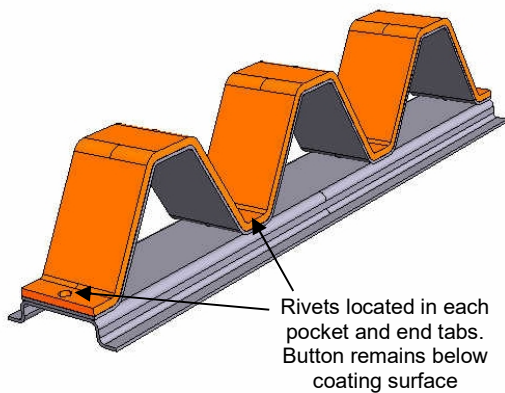
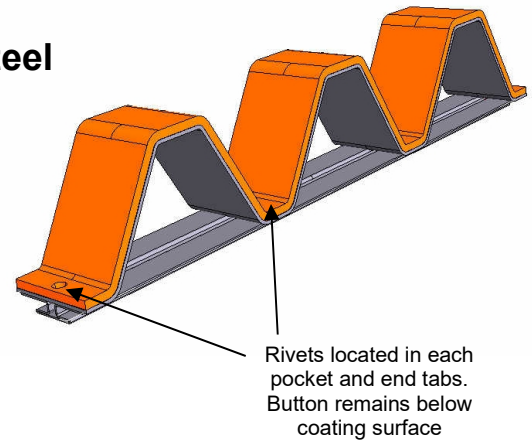

Steel Hat-Section

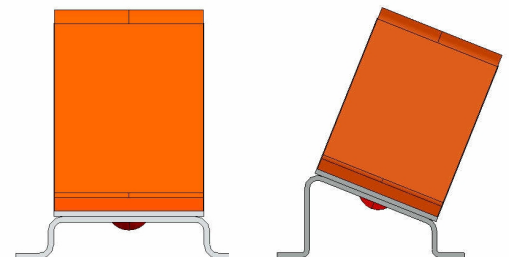

Hat-Section can be made from steel and painted or made from galvanized steel. It can be fastened with bolts, screws, or tack welds.